



WRITTEN IN STONE

EDUCATIONAL INSIGHTS AND COMPELLING PROJECTS

June 2016

CREATE AN UNFORGETTABLE IMPRESSION

Stonewood solid, phenolic panels are ideal for a wide range of project types offering:

- Low minimum order requirements
- Manufactured in America's heartland
- US Midwest-based customer service
- Competitive pricing
- Reliable on-time delivery

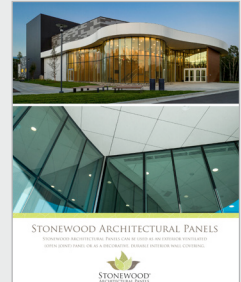

View our **NEW Corporate Overview** to learn more,
Stonewoodpanels.com

STATE-OF-THE-ART FACILITY FOR DOGS IN TRAINING

The newly renovated Leader Dogs for the Blind building in Rochester Hills, Michigan is adorned with 150 Stonewood Exterior Architectural Panels. Installed on the large soffits, the panels accent the beautiful, new Canine Development Center, an addition to the existing building

After three years of planning, and meeting with industry experts, the \$14.5M center will offer state-of-the-art space for leader dogs in training. The center features 255 dog suites, separate puppy and breeding areas, a centralized vet clinic, and a lobby with a puppy viewing area.

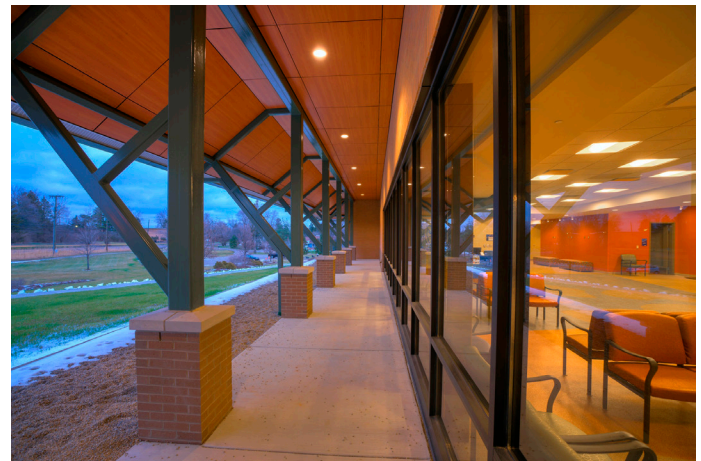

WHY STONEWOOD?

- **Cladding Built to Last:** Non-porous, easy to clean, high impact resistant
- **Straightforward Installation and Attachment:** Uses non-proprietary exposed fastener systems (exterior) or threaded fasteners (interior), on-site fabrication options
- **Panels for Every Purpose:** Exterior and Interior, suited for all construction types, Div. 07-42 (Solid Phenolic Exterior Wall Cladding), Div. 09 Finishes (Interior)
- **Environmentally Responsible:** Forest Stewardship Council certified manufacturing plant and products available, production energy sourced from in-house scrap materials
- **Made in America:** Manufactured in America's heartland, US-based Customer Service

Experience the Stonewood Difference Today!
Visit Stonewoodpanels.com, contact a Local Representative or call 262-567-4427

Fibersin Industries Inc | 37031 E. Wisconsin Avenue | P.O. Box 88 | Oconomowoc | WI | 53066