

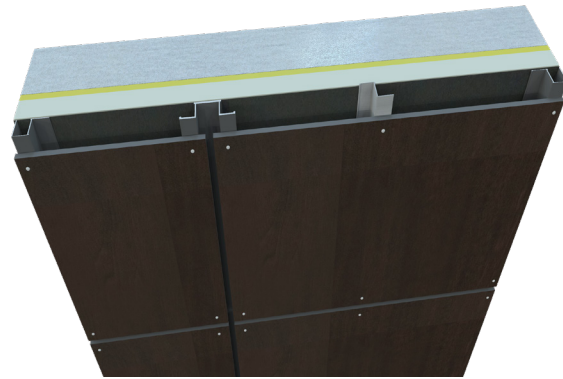

EF SYSTEM

- Economical and flexible
- For use with all panel sizes, 48" x 96" cut to size
- Use color matched fasteners or accent panels with contrasting color fasteners
- Flexible fabrication either on the job site or in factory
- Easily accommodates windows and other building penetrations



Stonewood Exposed Fastener (EF) System

CF SYSTEM

- Showcase the clean look and beauty of the panel by concealed fixing points on the back
- No complicated undercuts or expensive fastenings to retain mounting brackets
- Ideal for large format panels installed on continuous walls
- Use for all panel sizes, 48" x 96" cut to size

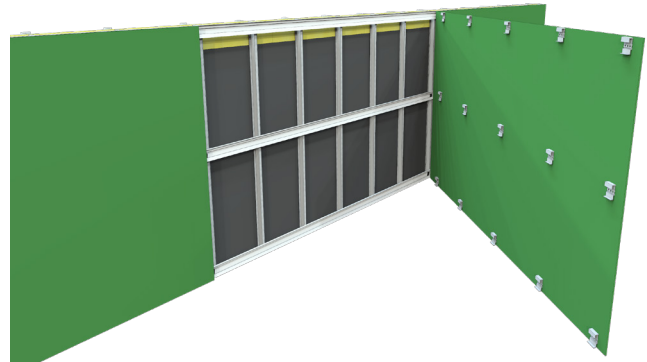

Stonewood Concealed Fastener (CF) System

STONEWOOD™ STACK

- Kerfed groove plank (8", 12", 16" nominal) slides onto corresponding horizontal rail
- Concealed fasteners create clean look, showcasing planks
- Uniquely suited for use on large, low-rise, continuous surfaces offering quick and easy installation
- Plank joint placement can vary without additional support structure
- Simplified specification

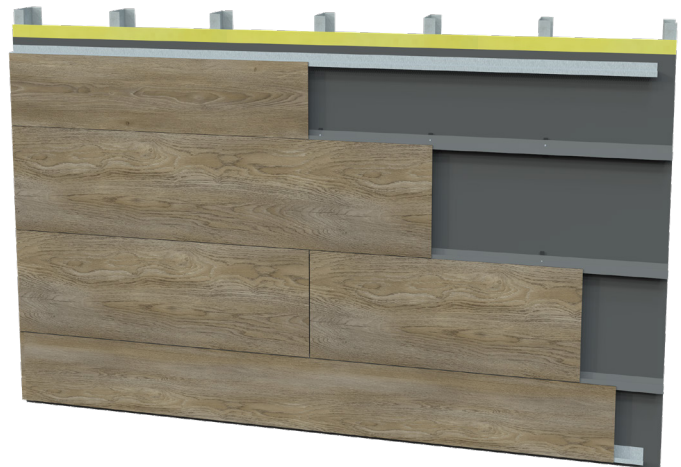

Stonewood Stack

STONEWOOD™ CLIP

- Factory-machined plank (8", 12", 16" nominal) lap joint, conceals clips for a clean look
- Clips create ventilated facade
- Cost effective solution for plank attachment
- Simplified specification, minimal parts

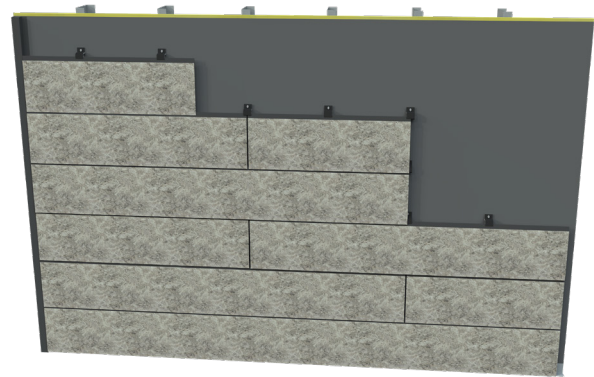

Stonewood Clip

STONEWOOD VERTICAL SIDING

- Kerfed groove plank slides onto corresponding vertical rail
- Concealed fasteners create a clean look, showcasing planks
- Easy to install, achieving a vertical plank look with a running bond of 50 percent
- Ideal for accent areas to complement other areas of the installation

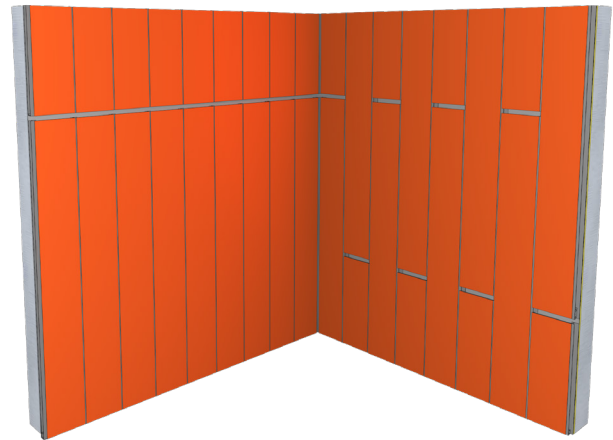

Stonewood Vertical Siding

Fastening System Quick Overview

	CF SYSTEM	EF SYSTEM	STONEWOOD™ STACK	STONEWOOD™ CLIP	STONEWOOD VERTICAL SIDING
Panel Sizes	48" x 96", Cut to size and planks	48" x 96" Cut to size and planks	Planks: 8", 12", 16" x 96"	Planks: 8", 12", 16" x 96"	Planks: 8", 12", 16" x 96"
Panel Thickness	3/8", 1/2"	5/16", 3/8", 1/2"	5/16"	5/16"	5/16"
Optimal Applications	<ul style="list-style-type: none"> • Large format panels • Plank applications • Continuous runs • Hidden fasteners are important 	<ul style="list-style-type: none"> • Large format panels • Plank applications • Complex exterior geometry 	<ul style="list-style-type: none"> • Low/medium rise buildings • Large surface areas 	<ul style="list-style-type: none"> • Low/medium rise buildings • Numerous rough openings 	<ul style="list-style-type: none"> • Accent areas, where vertical planks complement panel installation areas